

Paul Adams, AIA  
 Jose Alvarez, AIA  
 Franziska Amacher, FAIA  
 Jonathan Anderson, Assoc. AIA  
 Lauren Arington, AIA  
 Stephen Barasch, AIA  
 Daniel Barnum, FAIA  
 Dan Bartlett, AIA  
 Tom Bauer, AIA  
 Chris Beard, AIA  
 Rodney Bennett, AIA  
 John Benson, AIA  
 John Birath, AIA  
 Michael Blutt, AIA  
 Chad Boetger, AIA  
 Daniel Brogan, AIA  
 Robert Brown, FAIA  
 Nicole Brown, AIA  
 Michael Bucci, AIA  
 Greg Campbell, AIA  
 Alex Cassidy, AIA  
 Charles Chichester, AIA  
 Mike Cincala, AIA  
 Kevin Connors, AIA  
 Josh Cooper, AIA  
 Jim Dalton, FAIA  
 Joleen Darragh, AIA  
 Grant Davis, AIA  
 Pedro Delarosa, Assoc. AIA  
 Paul Dibos, AIA  
 Jennifer Dort, AIA  
 John Dugger, AIA  
 Merle Easton, AIA  
 Ladd Ehlinger, AIA  
 Faris Eid, AIA  
 Jerry Erbach, AIA  
 Larry Everhard, AIA  
 James Fausett, FAIA  
 Deborah Fein-Brug, AIA  
 Monica Fenderson, AIA  
 Karen Fenderson, AIA  
 Domenic Ferrante, AIA  
 John Ferrera, AIA  
 Ralph Fey, AIA  
 Peter Finsen, Assoc. AIA  
 Ginger French, AIA  
 Richard Gage, AIA  
 Alan Glassman, Assoc. AIA  
 Howard Glatstein, AIA  
 Fred Gleason, AIA  
 Ed Glowacki, AIA  
 Geoffrey Gogan, AIA  
 Eddie Gontram, AIA  
 Ken Gorski, AIA  
 Robert Green, AIA

Josh Gruner, AIA  
 David Hammel, AIA  
 Chuck Hardin, AIA  
 Jerry Hartsfield, AIA  
 Scott Hatfield, AIA  
 Ken Higa, AIA  
 Bradley Higdon, AIA  
 Gary Hilbert, AIA  
 Nicole Hilton, AIA  
 Patrick Huff, AIA  
 R. Perry Jarrell, AIA  
 Joseph Jimenez, AIA  
 Bruce Johnson, AIA  
 Len Johnson, AIA  
 David Joiner, AIA  
 Edgar Jorge-Ortiz, AIA  
 Wilson Kessel, Assoc. AIA  
 Barry Koren, AIA  
 Dale Kribbs, AIA  
 Bret Kudlicki, AIA  
 Sophorn Kuoy, AIA  
 Rodney Lamberson, AIA  
 Diego Lastres, AIA  
 Jeff Laur, AIA  
 Dan Lawrence, AIA  
 Andy Lawrence, AIA  
 Steven Lazarus, AIA  
 Nina Le Baron, AIA  
 Michel Lebel, AIA  
 Michael Lobuglio, AIA  
 Cory Lowery, AIA  
 William Lucus, AIA  
 David Mack, Assoc. AIA  
 Henry MacLean, AIA  
 Robyn McAdoo, AIA  
 Cheryl McAfee, FAIA  
 Patrick McFadden, AIA  
 Meg McLaurin, AIA  
 Jason Medina, Assoc. AIA  
 Gary Mendoza, AIA  
 George Metzger, AIA  
 Thomas Meyer, AIA  
 Scott Meyer, AIA  
 Martin Michaelis, AIA  
 John Miller, FAIA  
 Michelle Moraczewski, AIA  
 Michael Moyta, AIA  
 Ron Nance, AIA  
 Jordan Northcross, AIA  
 Stacey Oguinn, AIA  
 Masuo Okamoto, AIA  
 Kate O'Neil, Assoc. AIA  
 Marie Ortiz, Assoc. AIA  
 George Owen, AIA  
 Carole Pacheco, AIA

# LET US RAISE OUR VOICE

VOTE **YES** TO SUPPORTING  
A NEW WTC 7 INVESTIGATION

J. Mike Parnon, AIA  
 Norbert Peiker, FAIA  
 John Pesa, AIA  
 Neil Pinney, AIA  
 Craig Polhamus, AIA  
 Mike Pond, AIA  
 Rich Pontius, AIA  
 Dale Powers, AIA  
 Bob Probst, AIA  
 William Rakatansky, FAIA  
 John Ramsay, AIA  
 Ralph Raymond, AIA  
 Eve Reynolds, AIA  
 David Richardson, AIA  
 Daniel Roach, AIA  
 Marcia Roberts, AIA  
 Alan Robertson, AIA  
 Mark Robin, AIA  
 John Root, AIA  
 Mike Rosen, AIA

Uwe Rothe, AIA  
 Mark Rudolf, AIA  
 Angela Russ, Assoc. AIA  
 Mike Rutland, AIA  
 Boleslav Ryzinski, AIA  
 Heather Salisbury, AIA  
 John Salmen, AIA  
 Gisela Schmidt, AIA  
 Michael Seaman, AIA  
 Kian Shamloo, AIA  
 George Sincos, AIA  
 Louis Sirianni, FAIA  
 Andrew Smith, AIA  
 Jeffery Smith, AIA  
 Othelda Spencer, AIA  
 Jennifer Spencer, AIA  
 Jes Stafford, AIA  
 William Stanley, FAIA  
 Jonathan Stevens, Assoc. AIA  
 Ray Strang, AIA

Kevin Sullivan, AIA  
 Steve Sweat, AIA  
 Richard Taylor, FAIA  
 Walt Teague, FAIA  
 Brian Tibbs, AIA  
 John Titus, AIA  
 LeRoy Troyer, FAIA  
 Susan Turner, AIA  
 Vassilios Valaes, AIA  
 James Vignola, AIA  
 Keith Wales, AIA  
 Richard Wallace, AIA  
 Jonathan Warburg, FAIA  
 Henry Weinberg, AIA  
 Jane Weinzapfel, FAIA  
 Chip White, AIA  
 Andrew Wolff, AIA  
 David Woodward, AIA  
 Mark Wright, AIA  
 Faith Zimmerman, AIA  
 Hope Zimmerman, AIA



**BECOME A  
SPONSOR**

Join the **hundreds of AIA members** who will be sponsoring next year's resolution calling for the AIA to support a new WTC 7 investigation.



**MAKE YOUR  
VOICE HEARD**

Let your chapter representatives know that **you believe** the AIA should support a new WTC 7 investigation.



**LEARN MORE,  
GET INVOLVED**

Visit **AE911Truth.org** to learn more and get involved in our education and advocacy programs.



# OUR VOICE MATTERS

## ► DEAR FRIENDS AND COLLEAGUES,

Late in the afternoon on September 11, 2001, a 47-story high-rise known as **World Trade Center Building 7** fell completely and symmetrically into its own footprint after being on fire for several hours. More puzzling than the sudden, total demise of a building so large is the fact that we in the architecture community have spent so little time discussing it. Even 15 years later, many architects are still learning about it for the first time.

I remember watching news footage of the collapse that day and being stunned as I realized that something was very wrong. Really, one can tell just by looking at it: This building was demolished. Seven years later, the National Institute of Standards and Technology finally issued a report that was supposed to be the definitive explanation. As I delved into it, my fear that we would not get an honest answer was confirmed. Their model does not resemble the actual collapse. Their story is elaborate and truly far-fetched. The evidence, which they so clearly ignored, points overwhelmingly to controlled demolition. I'm confident that most of you who spend time looking into it will reach the same conclusion.

At the AIA National Convention this coming April, several hundred members will submit the enclosed resolution, which calls for the Institute to support a new investigation. When it comes time to vote, the question before us will not be a technical one, but a moral one: **Do we remain silent? Or do we have the courage to raise our voice for what is right?**

Some will say that this is not an issue for the AIA — that the architecture profession faces many other challenges to which we must devote our full energy. I submit to you that we have the capacity and the strength to include this among our many important goals. As the largest association of architects in the world, our voice carries tremendous weight. Thus, our responsibility to the public is equally tremendous. Only when we have the truth about the events of September 11, 2001, can our nation's healing truly begin.



Daniel Barnum, FAIA



# THE RESOLUTION



WTC 7 WAS A 47-STORY HIGH-RISE ON THE NORTH SIDE OF THE WTC COMPLEX.



WTC 7 CAME DOWN SYMMETRICALLY INTO ITS OWN FOOTPRINT, AT FREE-FALL ACCELERATION, IN UNDER SEVEN SECONDS.

**TITLE** Investigation of the Total Collapse of World Trade Center Building 7

**INTENT** To adopt a Position Statement declaring the AIA's support for a new investigation into the total collapse of World Trade Center Building 7 on September 11, 2001.

**WHEREAS**, thousands of members of the architecture and engineering professions, including the \_\_\_\_\_ sponsors of this resolution, now believe there is sufficient evidence contradicting the findings of the National Institute of Standards and Technology (NIST) to warrant a new investigation into the total collapse of World Trade Center Building 7 (WTC 7), a 47-story high-rise that collapsed into its own footprint at 5:20 PM on September 11, 2001;

**WHEREAS**, the cause of the total collapse of WTC 7 has become the subject of intense public debate, to which architects — through their knowledge, skill, and experience — are uniquely qualified to contribute; and

**WHEREAS**, prior to and since September 11, 2001, no steel-framed high-rise has ever suffered a total collapse, except buildings demolished through the procedure known as controlled demolition; and

**WHEREAS**, the total collapse of WTC 7 exemplified many of the signature features of controlled demolition, including:

- **Sudden onset:** The roofline of WTC 7 went from being stationary to being in free fall in approximately one-half second.
- **Rapidity:** The roofline of WTC 7 fell to the ground in less than seven seconds.
- **Free fall:** For 2.25 seconds of its descent, WTC 7 fell at the rate of gravity over a distance of eight stories, meaning that the lower structure of the building provided no resistance whatsoever.
- **Symmetry:** WTC 7 fell directly downward through what had been the path of greatest resistance, with the debris deposited mostly inside the building's footprint.
- **Explosions and window breakage:** Vertical sequences of explosions and window breakage could be seen running up the north face of WTC 7 as it began to collapse.



LEFT: FIRES IN WTC 7 SEEN FROM THE NORTH SIDE OF THE BUILDING.

RIGHT: AN AERIAL PHOTOGRAPH TAKEN ON SEPTEMBER 17, 2001, SHOWING WTC 7'S DISMEMBERED FRAME MOSTLY CONTAINED WITHIN THE BUILDING'S FOOTPRINT.

➤ **Dismemberment:** The steel frame of WTC 7 was almost entirely dismembered.

➤ **Pulverization:** Most of WTC 7's concrete was pulverized to a consistency of sand and gravel.

➤ **Totality:** The entire structure of WTC 7 collapsed to the ground, leaving no sections of the building standing; and

**WHEREAS**, first responders and bystanders reported explosions and other phenomena suggestive of controlled demolition immediately prior to and during the total collapse of WTC 7, as exemplified in the following statement by a New York University medical student who was interviewed on 1010 WINS radio moments after the collapse:

"[W]e heard this sound that sounded like a clap of thunder. Turned around.... [I]t looked like there was a shockwave ripping through the building and the windows all busted out.... And then about a second later the bottom floor caved out and the building followed after that"; and

**WHEREAS**, a CNN video camera captured the sound of an explosion coming from WTC 7 and the following statements prior to the onset of the collapse:

Unidentified voice: "You hear that?"

Voice of emergency responder #1: "Keep your eye on that building. It'll be coming down soon."

Voice of emergency responder #2: "Building is about to blow up, move it back.... We are walking back, there's a building about to blow up. Flame and debris coming down"; and

**WHEREAS**, numerous experts in controlled demolition and structural engineering have attested that the total collapse of WTC 7 could have been caused only by controlled demolition, as exemplified in the following statement made by Dutch demolition expert Danny Jowenko after viewing video of the collapse:

"This is controlled demolition.... It's been imploded. It's a hired job, done by a team of experts.... It's without a doubt a professional job"; and

“Building is about to blow up, move it back.... We are walking back, there's a building about to blow up.”

—UNIDENTIFIED EMERGENCY WORKER

“They simply blew up the columns and the rest caved in afterwards.”

—DANNY JOWENKO, DEMOLITION EXPERT

LET US  
RAISE  
OUR  
VOICE



“The specifics of the fires in WTC 7 and how they caused the building to collapse remain unknown at this time.... [T]he best hypothesis has only a low probability of occurrence.”

—FEMA, MAY 2002



“We were surprised that Tower 7 collapsed.”

—JONATHAN BARNETT,  
FEMA INVESTIGATOR

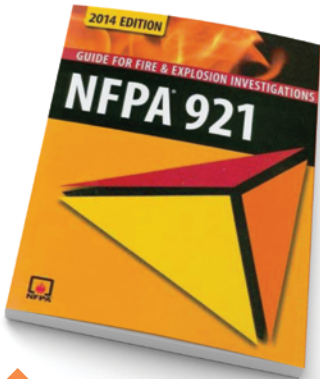

NFPA 921: GUIDE FOR FIRE AND  
EXPLOSION INVESTIGATIONS

“[T]ruthfully, I don’t really know. We’ve had trouble getting a handle on building No. 7.”

—DR. SHYAM SUNDER, MARCH 2006

**WHEREAS**, in spite of the fact that the fires in WTC 7 were unextraordinary and the building had only modest structural damage, the New York City Office of Emergency Management (OEM) began warning members of the New York Fire Department (FDNY) sometime before 11:30 AM that WTC 7 “was in serious danger of collapse,” and the FDNY proceeded to establish a safety zone around WTC 7 in the early afternoon; and

**WHEREAS**, officials at the scene were so certain of WTC 7’s impending total collapse that it became widely covered in the media, as exemplified by MSNBC’s Ashleigh Banfield, who reported, “I’ve heard several reports from several different officers now that that is the building that is gonna go down next. In fact, one officer told me they’re just waiting for that to come down at this point” — and by the BBC, who erroneously began reporting the total collapse 23 minutes before it actually occurred; and

**WHEREAS**, in spite of the fact that the total collapse of WTC 7 had been predicted with absolute certainty and accuracy starting six hours in advance, investigators for the Building Performance Study, conducted by the Federal Emergency Management Agency (FEMA) and the American Society of Civil Engineers (ASCE), were reportedly “stunned” by the collapse and concluded in May 2002:

“The specifics of the fires in WTC 7 and how they caused the building to collapse remain unknown at this time. Although the total diesel fuel on the premises contained massive potential energy, the best hypothesis has only a low probability of occurrence”; and

**WHEREAS**, NIST stated at the beginning of its investigation in August 2002 that fires “played a significant role” in the total collapse of WTC 7 — thus violating Sections 4.3.7 and 4.3.8 of NFPA 921: Guide for Fire and Explosion Investigations, which advise:

“Until data have been collected, no specific hypothesis can be reasonably formed or tested. All investigations of fire and explosion incidents should be approached by the investigator without presumption....” and,

“Expectation bias is a well-established phenomenon that occurs in scientific analysis when investigator(s) reach a premature conclusion without having examined or considered all of the relevant data.... The introduction of expectation bias into the investigation results in the use of only that data that supports this previously formed conclusion and often results in the misinterpretation and/or the discarding of data that does not support the original opinion”; and

**WHEREAS**, three and one-half years after NIST began its investigation, NIST’s lead investigator, Dr. Shyam Sunder, stated that NIST had some “preliminary hypotheses,” but conceded, “[T]ruthfully, I don’t really know. We’ve had trouble getting a handle on building No. 7”; and

**WHEREAS**, NIST finally concluded in 2008 — three years after the originally scheduled release of its WTC 7 report — that the total collapse of WTC 7 was caused by normal office fires that burned “at temperatures hundreds of degrees below those typically considered in design practice for establishing structural fire resistance ratings,” and ruled out earlier hypotheses that diesel fuel fires and structural damage contributed to the collapse; and

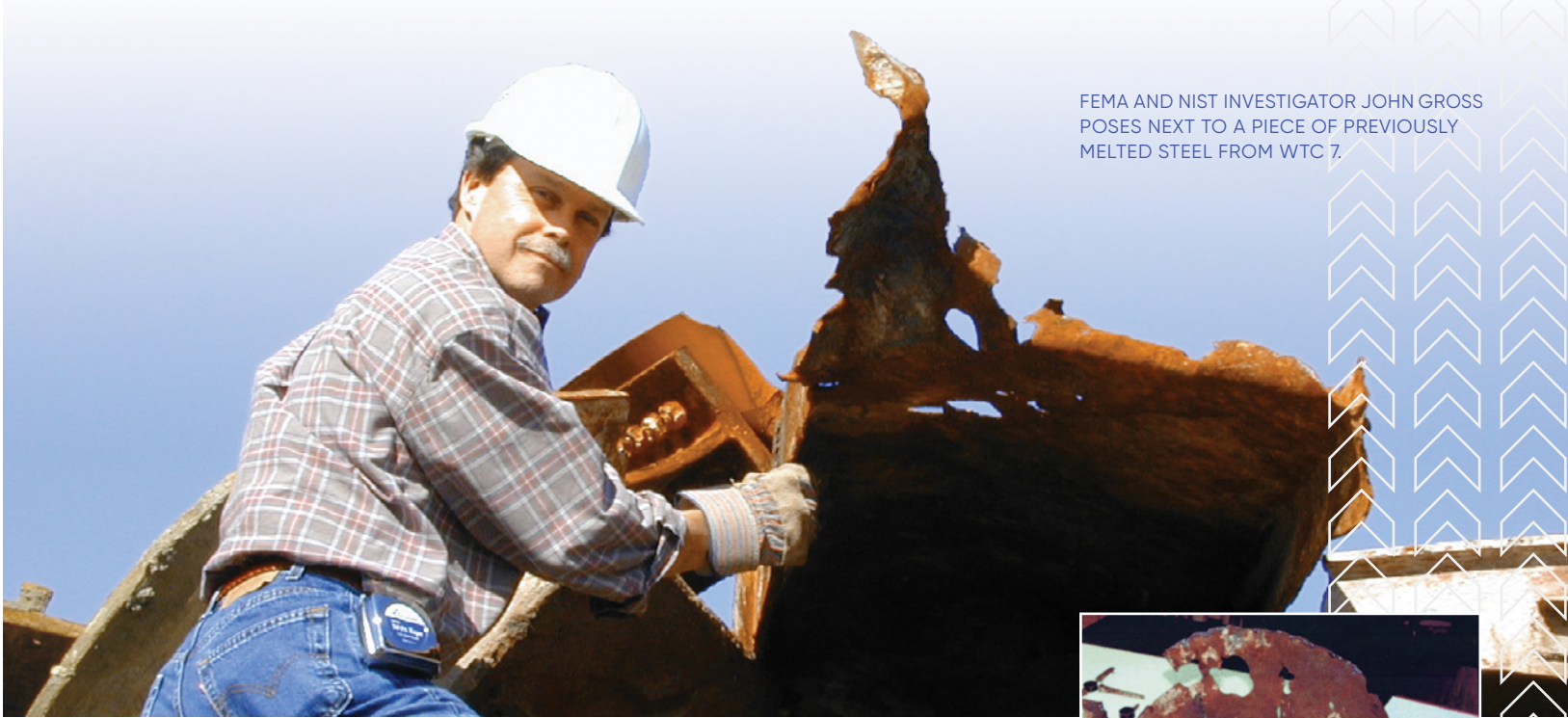

FEMA AND NIST INVESTIGATOR JOHN GROSS  
POSES NEXT TO A PIECE OF PREVIOUSLY  
MELTED STEEL FROM WTC 7.

**WHEREAS**, NIST declined to examine previously melted steel from WTC 7 that had a “Swiss cheese appearance,” and which had been documented in Appendix C of the FEMA/ASCE Building Performance Study as follows:

“Evidence of a severe high temperature corrosion attack on the steel, including oxidation and sulfidation with subsequent intergranular melting, was readily visible in the near-surface microstructure. A liquid eutectic mixture containing primarily iron, oxygen, and sulfur formed during this hot corrosion attack on the steel.... The severe corrosion and subsequent erosion of Samples 1 and 2 are a very unusual event. No clear explanation for the source of the sulfur has been identified”; and

**WHEREAS**, NIST’s computer model — which terminates less than two seconds into the seven-second collapse — fails to replicate the observed structural behavior, showing large deformations to WTC 7’s exterior not observed in the videos, while not showing the observed period of free fall; and

**WHEREAS**, NIST omitted critical structural features of WTC 7 from its computer model, which, in the opinion of independent engineers, if corrected, would show that the initiating failure reported by NIST had zero probability of occurring; and

**WHEREAS**, NIST has refused to release key portions of its modeling data to engineers studying the collapse of WTC 7, claiming that to do so “might jeopardize public safety” — thus making it impossible for any building professional in the world to independently verify NIST’s findings;

**NOW, THEREFORE, BE IT RESOLVED** that the AIA Board of Directors shall commence the process to adopt a Position Statement, to be published in the AIA Directory of Public Policies and Position Statements, declaring both:

- The AIA’s belief that incidents involving the catastrophic failure of buildings and other structures must be investigated using the highest standards of science-based investigation and analysis; and
- The AIA’s support for a new investigation into the total collapse of WTC 7.



PREVIOUSLY MELTED STEEL FROM WTC 7  
(THE SAME PIECE AS SHOWN ABOVE). THIS  
PHOTO IS TAKEN FROM APPENDIX C OF THE  
FEMA BUILDING PERFORMANCE STUDY.

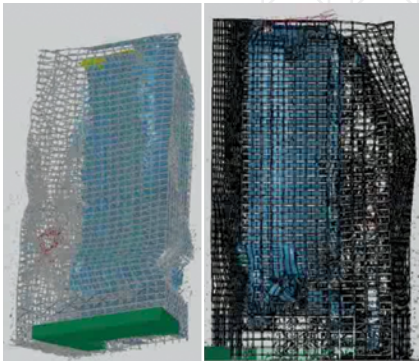

NIST’S COMPUTER MODEL TERMINATES LESS  
THAN TWO SECONDS INTO THE COLLAPSE.  
IT SHOWS LARGE DEFORMATIONS TO  
THE EXTERIOR NOT SEEN IN THE VIDEOS,  
AND DOES NOT SHOW ANY PERIOD  
OF FREE FALL. EVEN USING FAVORABLE  
ASSUMPTIONS, NIST’S MODEL FAILS TO  
REPLICATE THE OBSERVED BEHAVIOR.

# LET US RAISE OUR VOICE

VOTE **YES** TO SUPPORTING  
A NEW WTC 7 INVESTIGATION



“The question before us is this: Do we have the courage to raise our voice for what is right?”

— DANIEL BARNUM, FAIA



**BECOME A  
SPONSOR**



**MAKE YOUR  
VOICE HEARD**



**LEARN MORE,  
GET INVOLVED**

# RAISE YOUR VOICE

## BECOME A SPONSOR!

Members of the American Institute of Architects may submit a resolution for consideration at the AIA National Convention when at least 50 members sponsor the resolution.

More than 200 members are sponsoring this resolution as of November 2016 – but that is just the beginning. Add **your name** to the growing list of sponsors by mailing in this card before February 1, 2017.

☒ Yes, I would like to sponsor next year's resolution calling for the AIA to support a new WTC 7 investigation!

First Name \*

Last Name: \*

Designation (circle one) \* **Assoc. AIA** / **AIA** / **FAIA** AIA Member #:

State of Residence: \*

Phone # \* -- Email:

\* Required information

Your name and member # will be shared with the AIA. Your name may be displayed in promotional materials.

Email updates? **Yes / No**